

### DESCRIPTION:

SM6S Series TVS diodes can be used in sensitive electronics protection against voltage transients induced by inductive load switching and lighting, especially for automotive load dump protection application.

### FEATURES:

- ✧ Available in uni/bi-directional polarity.
- ✧ Low forward voltage drop & Low leakage current.
- ✧ High surge capability.
- ✧ Junction passivation optimized design passivated anisotropic rectifier technology.
- ✧  $T_J = 175\text{ }^\circ\text{C}$  capability suitable for high reliability and automotive requirement.
- ✧ Meets ISO7637-2 surge specification (varied by test condition).
- ✧ Meets MSL level 1, per J-STD-020, LF maximum peak of  $245\text{ }^\circ\text{C}$ .
- ✧ AEC-Q101 qualified.
- ✧ Compliant to ROHS Directive 2002/95/EC and in accordance to WEEE 2002/96/EC

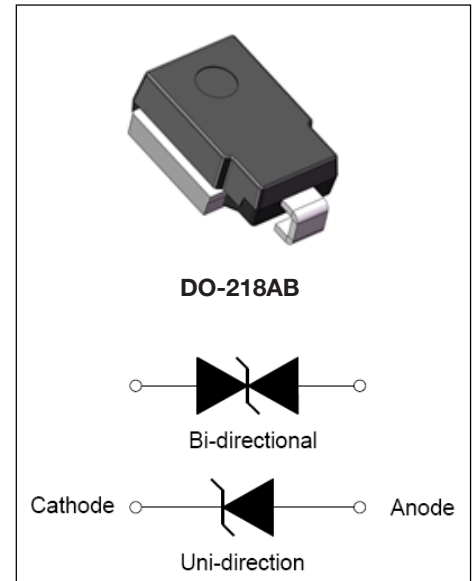

### Mechanical Data

**CASE:** DO-218AB Molding compound meets UL 94V-0 flammability rating Base P/NHE3-ROHS-compliant, AEC-Q101 qualified.

**Terminals:** Matte tin plated leads, solder able per J-STD-002 and JESD 22-B102, HE3 suffix meets JESD 201 class 2 whisker tests.

### ABSOLUTE MAXIMUM RATINGS ( $T_A=25\text{ }^\circ\text{C}$ , RH=45%-75%, unless otherwise noted)

Parameter	Symbol	Value	Unit
Peak pulse power dissipation on 10/1000us waveform	$P_{pp}$	4600	Watts
Peak pulse power dissipation on 10/10000us waveform		3600	Watts
Peak pulse current with 10/1000us waveform	$I_{pp}$	See next table	Amps
Power dissipation on infinite heat Sink at $T_C=25\text{ }^\circ\text{C}$	$P_D$	6.0	Watts
Peak forward surge current, 8.3ms single half sine-wave	$I_{FSM}$	600	Amps
Operating Junction and Storage Temperature Range	$T_J, T_{STG}$	-55 to +175	$^\circ\text{C}$
Typical thermal resistance, junction to case	$R_{\theta JC}$	0.95	$^\circ\text{C}/\text{Watt}$

### ELECTRICAL CHARACTERISTICS

Part Number		$V_R$	$I_R @ V_R$		$V_{BR} @ I_T$		$I_T$	$V_C @ I_{pp}$	$I_{pp}$
Uni-polar	Bi-polar	V	$\mu A @ 25^\circ C$	$\mu A @ 175^\circ C$	min(V)	max (V)	mA	V	A
SM6S10A	SM6S10CA	10.0	10	150	11.1	12.3	5	17.0	271.0
SM6S11A	SM6S11CA	11.0	10	150	12.2	13.5	5	18.2	253.0
SM6S12A	SM6S12CA	12.0	10	150	13.3	14.7	5	19.9	231.0
SM6S13A	SM6S13CA	13.0	10	150	14.4	15.9	5	21.5	214.0
SM6S14A	SM6S14CA	14.0	10	150	15.6	17.2	5	23.2	198.0
SM6S15A	SM6S15CA	15.0	10	150	16.7	18.5	5	24.4	189.0
SM6S16A	SM6S16CA	16.0	10	150	17.8	19.7	5	26.0	177.0
SM6S17A	SM6S17CA	17.0	10	150	18.9	20.9	5	27.6	167.0
SM6S18A	SM6S18CA	18.0	10	150	20.0	22.1	5	29.2	158.0
SM6S20A	SM6S20CA	20.0	10	150	22.2	24.5	5	32.4	142.0
SM6S22A	SM6S22CA	22.0	10	150	24.4	26.9	5	35.5	130.0
SM6S24A	SM6S24CA	24.0	10	150	26.7	29.5	5	38.9	118.0
SM6S26A	SM6S26CA	26.0	10	150	28.9	31.9	5	42.1	109.0
SM6S28A	SM6S28CA	28.0	10	150	31.1	34.4	5	45.4	101.0
SM6S30A	SM6S30CA	30.0	10	150	33.3	36.8	5	48.4	95.0
SM6S33A	SM6S33CA	33.0	10	150	36.7	40.6	5	53.3	86.0
SM6S36A	SM6S36CA	36.0	10	150	40.0	44.2	5	58.1	79.0
SM6S40A	SM6S40CA	40.0	10	150	44.4	49.1	5	64.5	71.0
SM6S43A	SM6S43CA	43.0	10	150	47.8	52.8	5	69.4	66.0

Note:

①. For all types maximum VF = 1.9 V at IF = 100 A measured on 8.3 ms single half sine-wave or equivalent square wave, duty cycle = 4 pulses per minute maximum.

②. Surge waveform: 10/1000 $\mu$ s

$V_R$  : Stand-off Voltage -- Maximum voltage that can be applied

$V_{BR}$ : Breakdown Voltage

$V_C$ : Clamping Voltage -- Peak voltage measured across the suppressor at a specified  $I_{pp}$

$I_R$ : Reverse Leakage Current

$I_T$ : Test current

## ORDERING INFORMATION

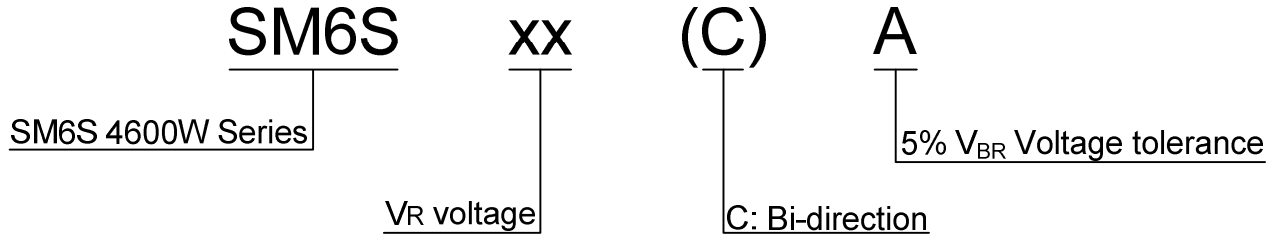

## RATINGS AND CHARACTERISTICS CURVES ( $T_A=25^\circ\text{C}$ , unless otherwise noted)

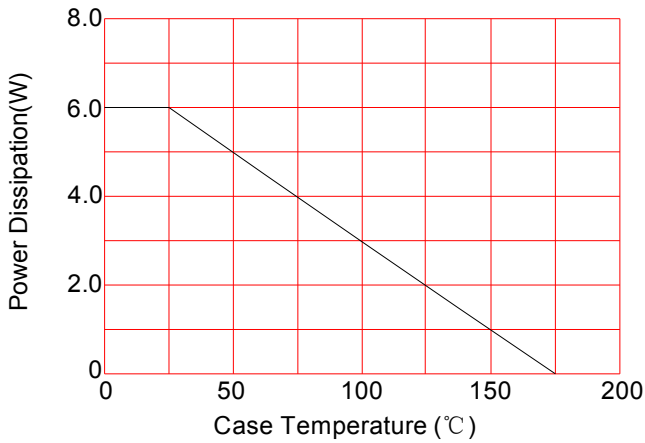

**FIG.1: Power Derating Curve**

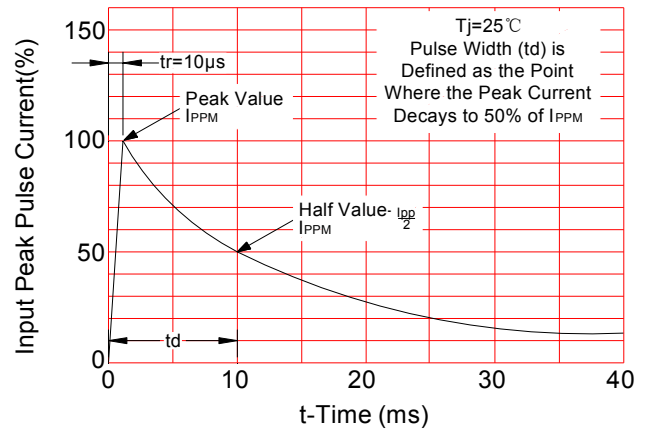

**FIG.2: Pulse Waveform**

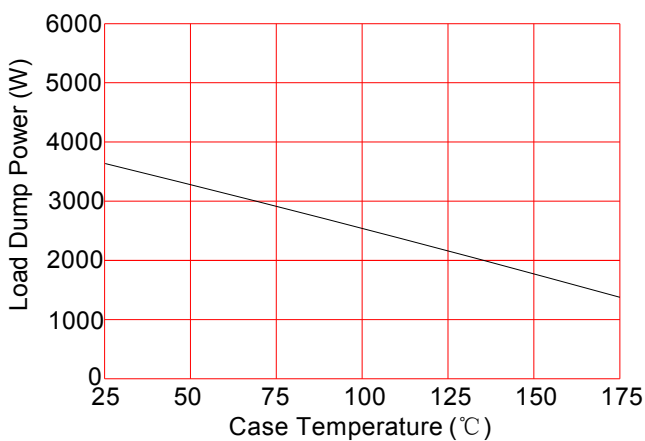

**FIG.3: Load Dump Power Characteristics (10ms Exponential Waveform)**

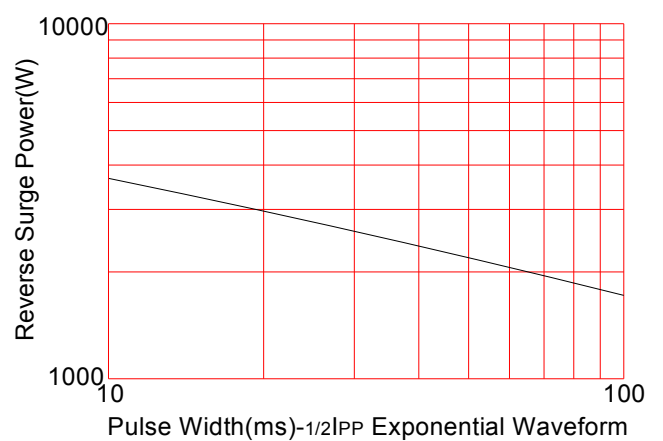

**FIG.4: Reverse Power Capability**

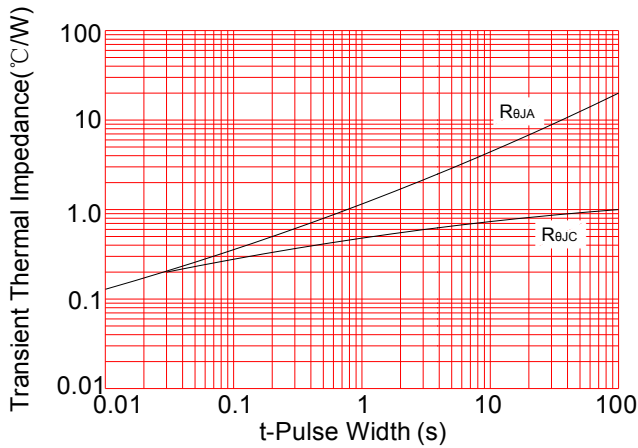

**FIG.5: Typical Transient Thermal Impedance**

## SOLDERING PARAMETERS

Reflow Condition		Pb-Free assembly (see FIG.5)
Pre Heat	-Temperature Min ( $T_{s(min)}$ )	+150°C
	-Temperature Max( $T_{s(max)}$ )	+200°C
	-Time (Min to Max) (ts)	60-180 secs.
Average ramp up rate (Liquid us Temp ( $T_L$ ) to peak)		3°C/sec. Max
$T_{s(max)}$ to $T_L$ - Ramp-up Rate		3°C/sec. Max
Reflow	-Temperature( $T_L$ )(Liquid us)	+217°C
	-Temperature( $t_L$ )	60-150 secs.
Peak Temp ( $T_p$ )		+260(+0/-5)°C
Time within 5°C of actual Peak Temp ( $t_p$ )		30 secs. Max
Ramp-down Rate		6°C/sec. Max
Time 25°C to Peak Temp ( $T_p$ )		8 min. Max
Do not exceed		+260°C

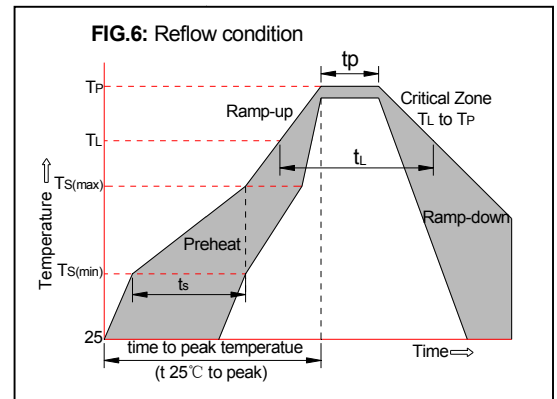

## PACKAGE MECHANICAL DATA

DO-218AB

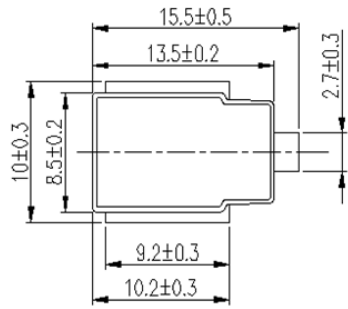

贴装端布局及尺寸

